



[www.davincisign.com](http://www.davincisign.com)

IN OPENING & REVIEWING THIS SIGN DESIGN/DRAWING, YOU AGREE TO NOT DISTRIBUTE, EXHIBIT OR USE THE ARTWORK TO CONSTRUCT DERIVATIVE WORKS.

THIS DESIGN PACKAGE IS THE RESULT OF DAVINCI SIGN SYSTEMS, INC. SALES, DESIGN & ESTIMATING TEAM'S ORIGINAL WORK AND IS SUBMITTED FOR THE SOLE PURPOSE OF YOUR CONSIDERATION TO PURCHASE. IT IS THE EXCLUSIVE PROPERTY OF DAVINCI SIGN SYSTEMS, INC. ANY USE OR REPRODUCTION WITHOUT WRITTEN PERMISSION FROM DAVINCI SIGN SYSTEMS, INC. IS STRICTLY PROHIBITED.

All of us at DaVinci Sign Systems, Inc. *sincerely* thank you for your cooperation.

 Copyright 2018  
DaVinci Sign Systems

*the art and science of identification*

Phone: (970) 203-9292 Fax: (970) 203-9293  
4496 Bents Dr. Windsor, Colorado 80550  
Denver Metro: (303) 573-7446  
Cheyenne Wyoming: (307) 220-4316





**Job Name:**

**CITY OF  
LONGMONT**

**Address:**  
HWY 119 & FAIRVIEW  
LONGMONT, CO

**Designer:** DALLAS GRIFFIN

**Sales:** NEIL HUGHES

**Scale:** Noted

**Date:** 2.15.18

**Revisions:**

**DaVinci Approval:**

**Date:**

**Customer Approval:**

**Date:**

**Without Changes**

**With Changes As Shown**

**Electrical hookup by others.**

**Electrical requirements: 120V or as indicated.**

**All landscaping by others.**

*This artwork is copyrighted, and the exclusive property of DaVinci Sign Systems. It is the result of the original work of its employees, and is submitted to your organization for the sole purpose of your consideration of whether to purchase from DaVinci Sign Systems. Distribution or exhibition of this artwork to anyone other than employees of your organization, or the use of this artwork to construct a similar sign is strictly prohibited. In the event your organization fails to comply with the stipulations outlined above, DaVinci Sign Systems expects to be compensated minimum \$5000 for its original design work. At any time you may purchase this artwork for \$5000, at which point you may use it however you see fit.*

**Sales Approval:**

**Date:**

**Production Approval:**

**Date:**

**Design #**

**18-205**

**Page: 1 of: 1**

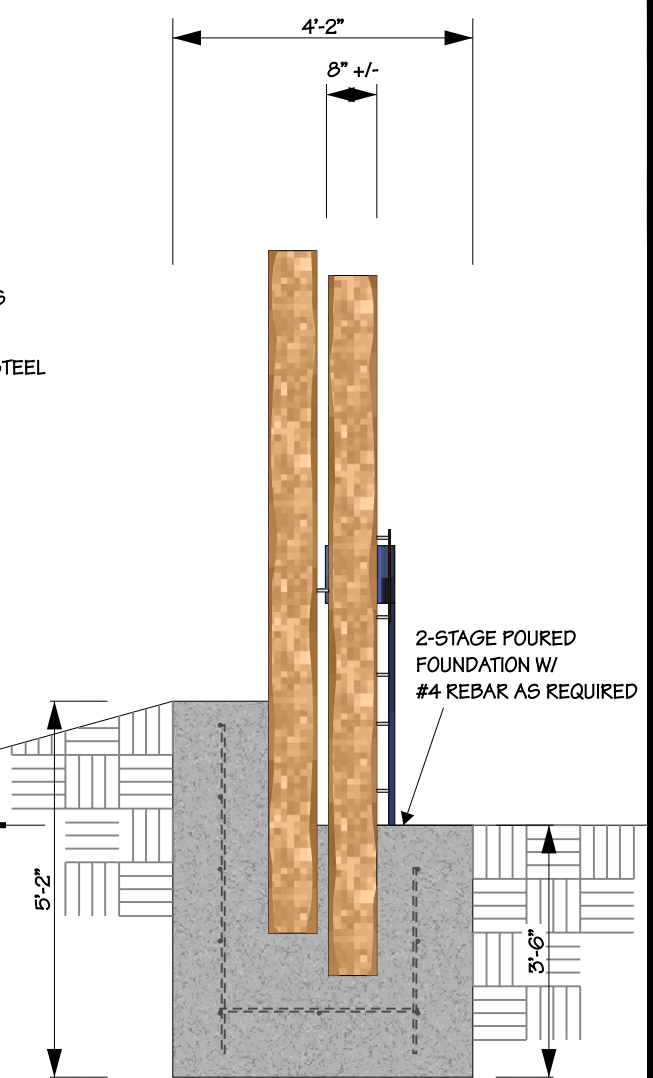
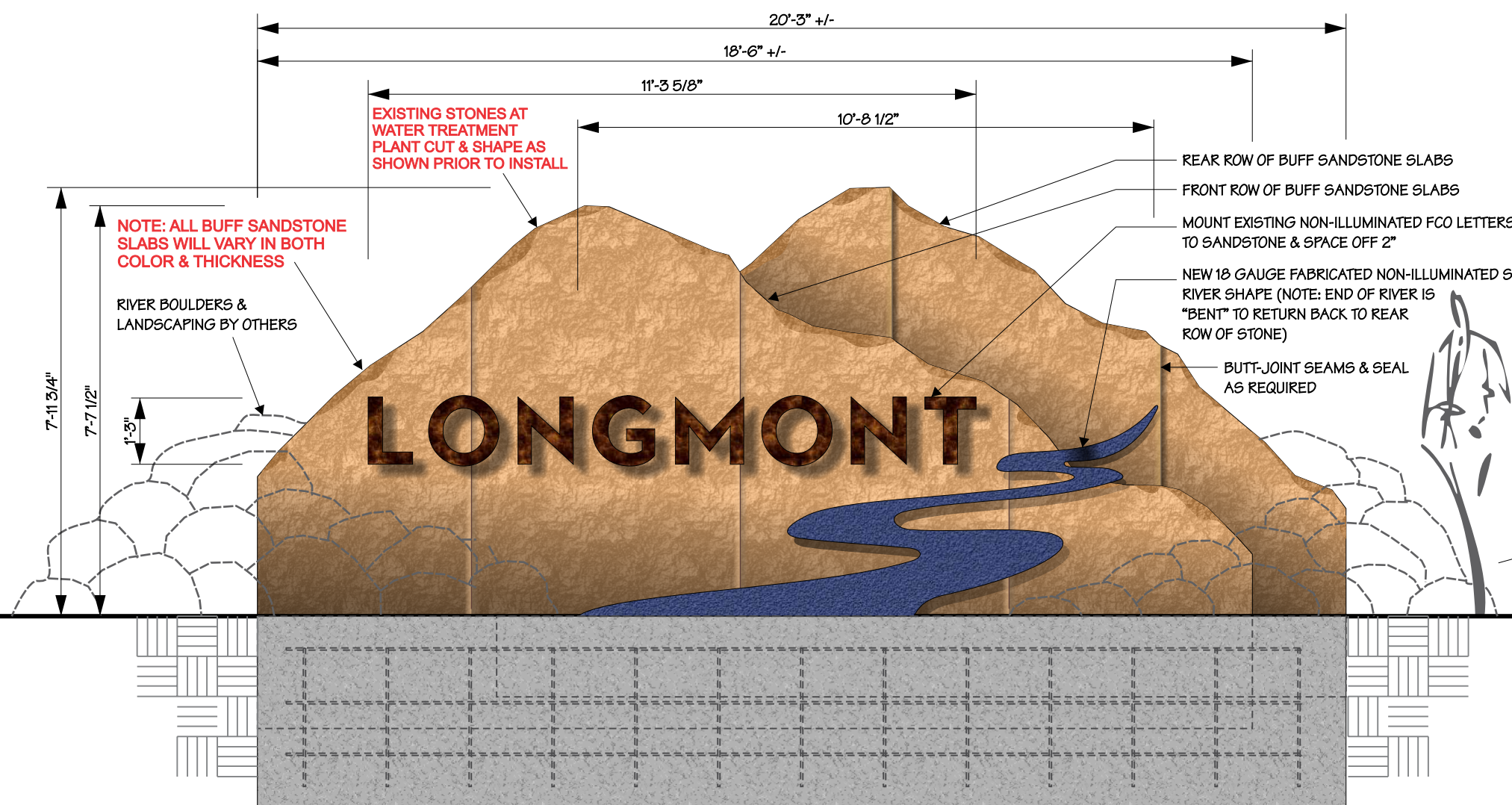

**1** S/F NON-ILLUMINATED MONUMENT SIGN  
**QUANTITY: 1 MANUFACTURE AND INSTALL**

SCALE: 3/8"=1'-0"

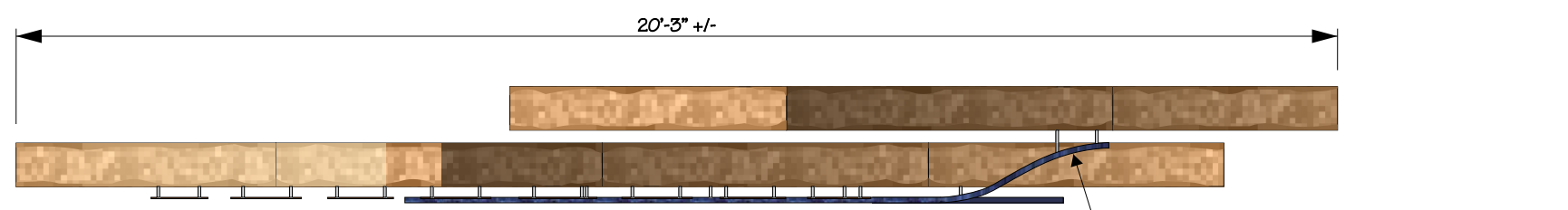

PLAN VIEW SCALE: 3/8"=1'-0"

1" DEEP 18 GAUGE FABRICATED NON-ILLUMINATED STEEL RIVER SHAPE (NOTE: END OF RIVER IS "BENT" TO RETURN BACK TO REAR ROW OF STONE)

**COLOR KEY**

PAINT: TEX-COTE & FINISH TO APPROX. MATCH FEDERAL 25095

THE COLORS DEPICTED ON THIS RENDERING MAY NOT MATCH ACTUAL COLORS ON FINISHED DISPLAY UNLESS OTHERWISE NOTED. PLEASE REFER TO SPECIFIED SAMPLES OR COLOR CHARTS FOR APPROVED COLOR SPECIFICATIONS.